

CastleRock™ Porcelain (NFPA 285)

Installation Guide for Lap, Flush & Brick Cladding Panels



CastleRock™ Laboratory Testing Information

CastleRock™ Cladding – Patented in US #8,176,701 B2 & Canada 2,588,294. Test reports and certifications are listed below: ICAP is a division of CastleRock Building Products, Inc.

Intertek/Warnock Hersey Test Reports W/N 20269

Intertek test reports available at www.spec-direct.com

Installation Guides available at www.CASTLEROCK.com

Or by contacting us at icap.sales@gmail.com



Testing conducted in accordance with the following:

Evaluation Guide: ICC EG 315

ASTM E330(2002): “Standard Test Method for Structural Performance for Exterior Windows, Doors, Skylights and Curtain Walls by Static Air Pressure Difference”

ASTM E84(2009) -08a “Standard Test Method for Surface Burning Characteristics of Building Materials”

CAN/ULC S102 (2007) “Standard Test Method for Surface Burning Characteristics of Building Materials”

ASTM C578 “Standard Test Methods for EPS Foam”

ASTM C1008 Standard Specification For Thin Brick Veneer Made From Clay or Shale.

ASTM 1405 Standard Specification for Glazed Brick (Single Fired Brick Units).

Summary

ASTM E84, CAN/ULC S102 (2007)

Flames Spread Rating: 0

Smoke Generation Rating: 0

ASTM E330(2002) “Standard Test Method for Structural Performance of Exterior Windows, Doors, Skylights and Curtain Walls by Static Air Pressure Difference”

Ultimate Load: 127 PSF

Note: NFPA 285 Series Available

Workmanship

This Installation Guide assumes the construction personnel have knowledge of the materials described and their proper methods of installation. The manufacturer recommends certified installers be used to install ICAP products. Installer certification is available through the CASTLEROCK "Factory Certified Installer" program. Contact us at 208-895-8557 for details.

Preparation

Prior to commencing activity related to the scope of this Guide, review all adjacent products and other subcontractor work that precedes the installation of CASTLEROCK cladding ensure proper workmanship is reflected and that there are no recognizable errors or deficiencies.

Building Code Requirements

Building code requirements vary from area to area. Check with local authorities for building code requirements for your area and application. Carefully read all sections of this guide and follow the manufactures Installation Instructions before proceeding with your ICAP application. In the event the local building codes conflict with other statements made in this document, contact the manufacture for additional guidance.

Material Requirements:

Flashing

All flashing and flashing accessories must be corrosion resistant materials and integrated with the WRB materials or flashings recommended by the air/water resistant barrier manufacturer for use with their products. Flashing must be installed at all through the wall penetrations and at terminations of ICAP panel system, around doors, windows and other protrusions in accordance with local building codes.

Weep Screed

Some jurisdictions require weep screeds or termite barriers. These must be made of corrosion resistant metal a minimum of .019 inches or 26 gage thickness.

Walls and Wall Systems

CASTLEROCK ICAP Substrate Panels are designed to attach to the following wall substrates with manufacturer approved fasteners. See table on the next page to determine the appropriate fastener for your application. Some areas require stainless fasteners.

Recommended Clearances:

- ICAP Cladding Panels individually attach to the wall or studs and do not require a brick ledge support like masonry products.
- Check with your local building official for requirements above grade and concrete/paving in your area. (slope away from the structure in accordance with local building requirements)
- CASTLEROCK™ is a cladding product and all components used in its manufacture are waterproof. Consult with your local building official regarding requirements in your area.

Cautions:

- Do not subject CASTLEROCK™ Claddings to frequent water contact such as sprinklers or direct spray. Place downspouts or drainage pipes so the water is not frequently contact the cladding.
- Do no subject CASTLEROCK™ to contact with de-icing materials, salt, asphalt roofing material or its drainage, or other harsh chemicals. Prolonged exposure may damage the fascia or panel.
- Do not expose the EPS foam portion of the panel to extended periods of sunlight. All surfaces for EPS must be covered with fascia, flashing, other materials to protect it from UV exposure.

Fasteners, Spacing and Wind Load Ratings

Substrate Application	ICAP Panel Fastener	Size	Spacing
Plywood/OSB	Staples	ICAP Part #STA-025 1" crown x 2-1/2" Leg	3" or less O.C.
Wood Studs with Plywood/OSB Sheathing	Screws & ICAP Washer: Washer: 1-1/4" x .060 plated fender washer Screw: #10x3" Zinc Plated or Stainless Coarse Auger Thread, Type 17 Point	ICAP Part# SCW-103	To Studs 16" O.C. Max. & 4" O.C. to sheathing
Metal Studs with 1/2" MgO Cladding or equivalent	ICAP Screw and washer Washer: 1-1/4" x .060 plated fender washer Screw: #10x3" Zinc Plated T-25 Drive, Coarse Auger Thread, Type 17 Point	ICAP Part# SCW-4	To Studs 16" O.C. Max. & 4" O.C. to sheathing
Concrete or Concrete Masonry Block (CMU)	ICAP Screw and washer Washer: 1-1/4" x .060 plated fender washer Screw: #10x3" Zinc Plated T-25 Drive, Coarse Auger Thread, Type 17 Point	ICAP Part# SCW-4	To Studs 16" O.C. Max. & 4" O.C. to sheathing
Concrete or Cement Block (CMU)	Fastener: RAMSET Part #1524SDP 3" smooth, straight shank pins with washers	Part #1524SDP 3"	8" O.C. Avoid Grout Joints

Wind Load Testing

<u>Model#</u>	<u>Evaluation Property</u>	<u>Ultimate Load PA (PSF)</u>	<u>Comments</u>	<u>Fasteners</u>	<u>Maximum Panel Size</u>
ICAP- 88	Uniform Load	88	R-8 to R-20 Panel	Screws to studs 16" OC	24" x 120"
ICAP-106	Uniform Load	106	R-8 to R-20 Panel	Screws to studs & OSB - 8" OC	24" x 120"
ICAP-127	Uniform Load	127	R-8 to R-20 Panel	Staples: 1" crown 3" OC to OSB or Plywood	24" x 120"
ICAP-200	Uniform Load	200	R-8 to R-20 Panel with metal back	Screws to Studs & OSB - 4" OC	8-1/2" x 120"

Fasteners



SCW-003

Wood Studs: Standard ICAP Screw/Washer Assembly: #10 x 4"
Zinc Plated or Stainless Steel— #2 square Drive, Course Auger Thread, Type 17 Point. Used to attach EPS Foam Panels to wood Studs.and OSB 8" O.C. (Non-NFPA 285) (Gold Colored Screw)
Screw length varies with sheathing thickness.

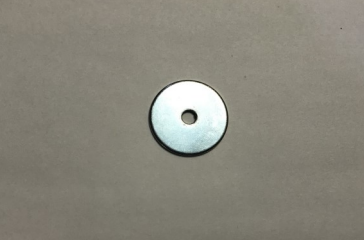

WAS-114

1-1/4" Fender Washer: Used on tongue flanged to attach foam panels to wood or metal studs and on 8" centers.



STA-212

TEK Screw - Used with 1-1/4" Fender Washer (WAS-00114) to attach ICAP foam panels to metal studs. Self-drilling/tapping #9 x 3" Zinc Plated or Stainless Steel square or torque head screws used with #WAS-00114 washer through tongue flange to attach panels to metal studs. Screw length varies with sheathing thickness.



SSO-002

Starter Strip Fastener - #9 min. x 2" Zinc Plated or Stainless Steel—T-25 Torque Drive, Course Auger Thread, Type 17 Point. Used to attach Starter Strip. Screw length varies with sheathing thickness.



SSO-048

Starter Strip: 48" long section of the starter strip used at the bottom of the wall to receive the groove flange of first row of panels.

Tools Required

Sheathing	Tool	Fasteners
OSB or Plywood	ICAP Staples Gun	1" x 2-12" Staples
Studs (wood or metal)	Screw Gun & Drivers	See Screws/washers
All Sheathing	Sliding Miter or Masonry Saw - Porcelain Diamond Tile Saw Blade	
Misc. Cuts	Right Angle Grinder –diamond Blade	
Construction Tools	Scaffolding, Ladders, Hand Tools	
Tile Tools	Tools Joint	
Hot Knife Foam Cutter	ICAP Grooving Blades	

Fastener Installation:

Install all fasteners horizontal as illustrated below. Fasteners must be located in the foam area of the panel and not impede the ability of the groove of the next panel to interlock.

Note:

1. Staple Location: 3" O.C.
2. Set air pressure so that Staple is head is flush with front of foam.
3. Staple 1" crown x 2-1/2"

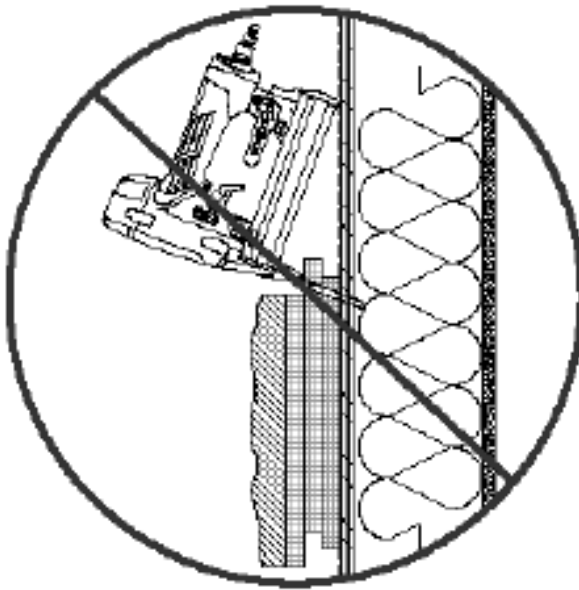

INCORRECT METHOD

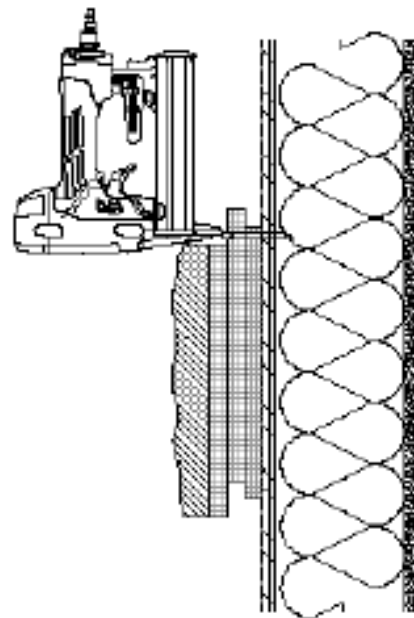

CORRECT METHOD

Mechanical Panel Attachment

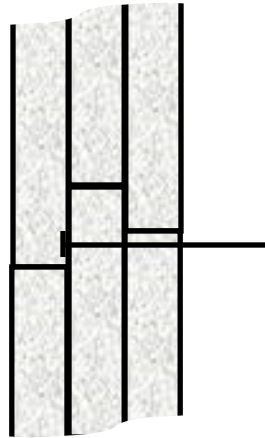

Caulking and Flashing Instructions

Caulking Trim: All end joints and borders of porcelain trim which transition from brick, porcelain or other materials are to be caulked and/or flashed to prevent water penetration.

Flush Grout-less Porcelain: Install using lippage tools as shown which create a 1/16" space between tiles.

Lap jointed Porcelain: Lap jointed porcelain does not require sealing at joints, but does require caulking where at window/doors, trim or transitions to another material to prevent water intrusion.

Flashings and Metal Trims:

All transitions, caps, etc. require appropriate flashing as specified in construction plans and by the architect. If details of flashing do not exist, consult your local building official, construction manager or the IBC or IRC building codes. Seal water-tight at all penetrations and transitions to other materials.

Flush Panel installation requires the use of an anti-lippage tool to align the face of the porcelain flush and straight. These tools are inexpensive, easy to use and reusable.

Dollops of silicone adhesive (1199) are applied between the foam and the weather barrier along the joining edge of the panels to create a "spacer" which holds the panel in alignment with the flush face of the porcelain. Allow 48 hours for the silicone to adequately set, then remove the lippage tools. A space of 1/16" between tiles will allow for movement, expansion and contraction. The joints are designed to be "non-grouted" to allow movement without the tile touching each other.

Flush Porcelain Panel Installation

Flush Panel Anti-lippage Tool Placement

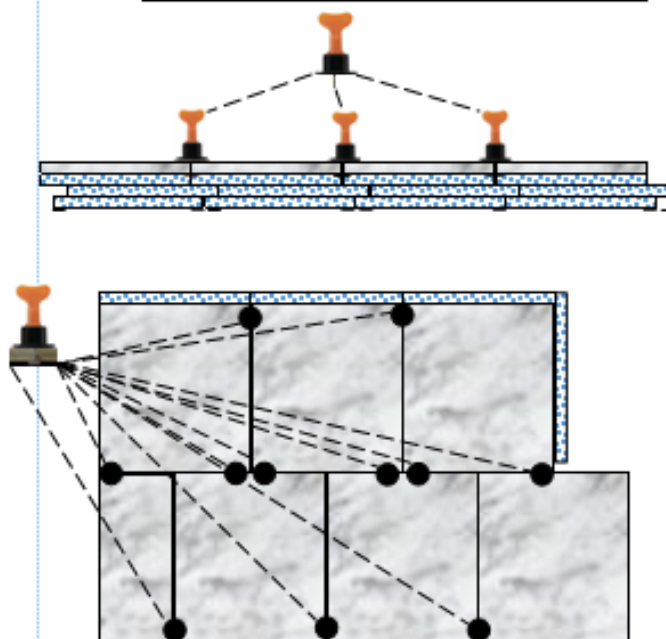

Method for installing CastleRock Flush Porcelain Panels

Step #1

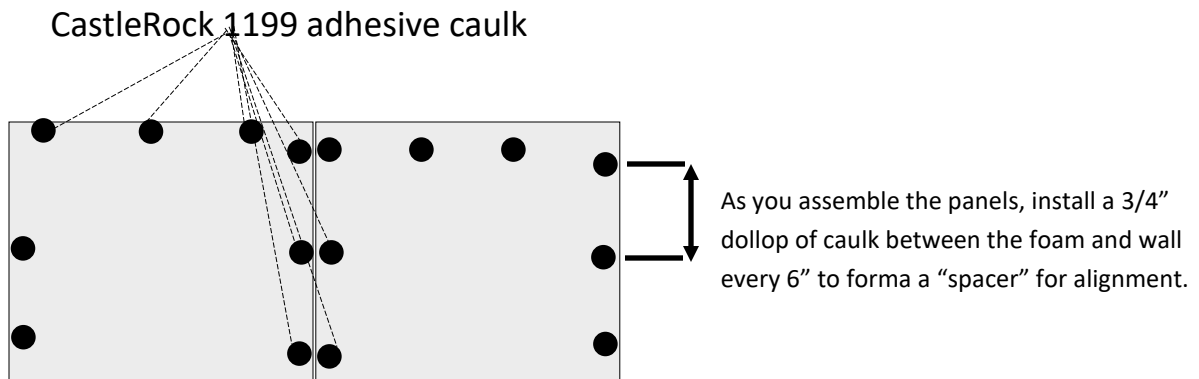

Install dollops of CastleRock 1199 at the locations above between the foam panel and weather resistive barrier. The purpose of the caulk is to form a spacer that will fill irregularities in the wall, harden and hold the porcelain fascia flush on the front. Install the "anti-lippage tools as shown and screw the nut portion tight against the porcelain. See location pattern below. Leave the anti-lippage tools in place for at least 48 hours to allow the caulk to firmly set. After removal of the lippage tools, they can be reused.

Step #2

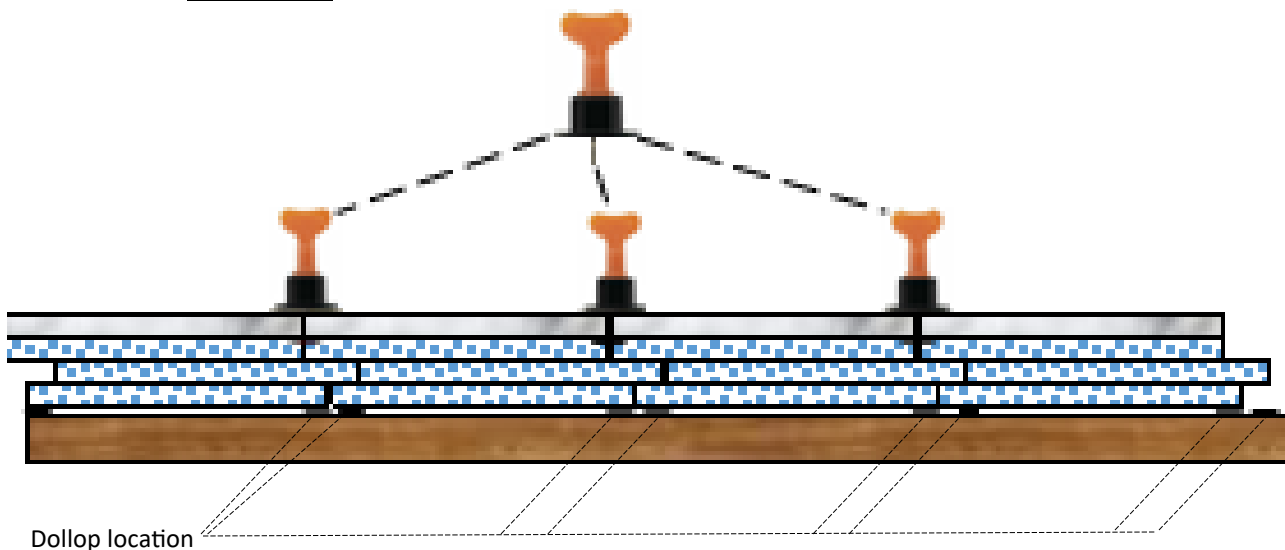

Installing Flush Porcelain Siding on uneven walls

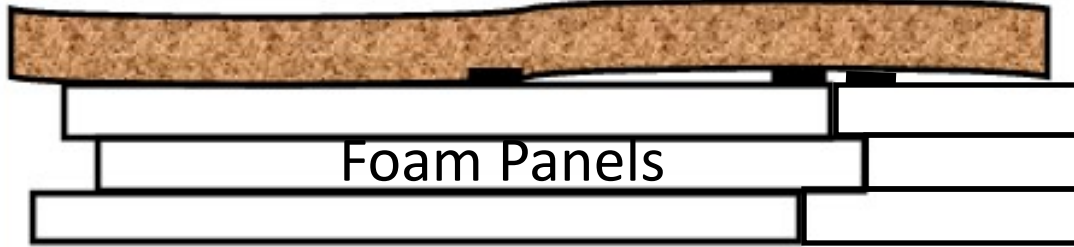

Lippage tool is used when irregular walls cause the face of the porcelain to be uneven and misaligned. Walls are often not flat & this is one solution.



- 1 Paving the first tile, leave more than 1.5mm/0.06in. Close to the tiles.



- 2 Insert T-shaped needle along the gap in the tile. Then 90 degree rotation, T-shaped needle stuck at the bottom of the two tiles.

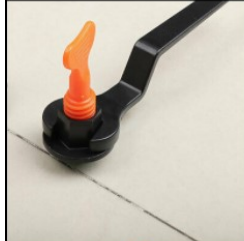

- 3 Adjust the caps with your hand/special wrench until the two tiles are on the same level.

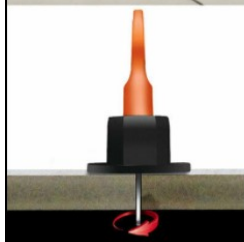

- 4 Allow about 48 hours after leveling, for the silicone adhesive to set before removing the lippage tool. Rotate the nut on the tool in the reverse direction, then turn the T-handle 90 degrees to remove.

Installation Instructions:

1. Panel assembly on an approved liquid applied-Weather Resistant Barrier is required. As you assemble the panels follow this procedure.
2. Apply a 3/4" inch dollop of silicone caulk between the wall and the WRB to create a spacer between the foam and wall.
3. Use the reusable lippage device as shown to align the face of the panel. The tool will align the panel face and hold it in place while the silicone adhesive cures. Allow 48 hours to cure before removing the tool. Tool can be re-used on the next section of wall.
4. Lippage devices are very inexpensive and reusable. Only use the wrench tool if absolutely necessary. Be careful not to overtighten.

CastleRock™

Installation Guide - Flush & Lap Siding Panels

Note: The ICAP system of modular panels still requires custom cutting and fitting at protrusions, doors and windows. Several methods are available as shown on page 10 and covered in the certified training program

Panel Installation

Panel placement General:

The tongue flange must always be placed upward to prevent water intrusion into the wall. The panels are designed to be installed from bottom row and ***left to the right no more than 2 rows at a time***. Inspect each panel for flaws or damage prior to attaching to the wall. Use a leveling method to ensure each row is straight and level before attaching to the wall or proceeding to the next row.

1. **Inspect the wall to assure correct fit of substrates and framing. Studs: 16” or less on center cladding meeting the requirements. A liquid applied weather resistant barrier or equivalent complying with local building codes is required by CastleRock™.** Determine its desired location in regard to elevation and relationship with the foundation, windows and other openings to align with the cladding height and width. Panels may be trimmed to fit at openings, but pre-planning can save work and effort. Plan for termination at windows, doors, projections and upper terminations. See instructions in this manual for details of termination points.
2. **Fastener Attachment Pattern:** Secure the panels to the wall using the specified fasteners and locations at the specified spacing. See fastener chart on page 3 of this manual.
3. **INSTALLING CLADDING PANELS (C-Series—Non-NFPA 285)**
 - a. **STARTER SECTIONS:** Determine the location of the bottom panels and install the J-hook shaped “starter section” Part # SSS-048 at bottom of the wall and lap it a minimum of 1” (25.4 mm) over the foundation. Attach every 6” (152.4mm) to the plate or studs with appropriate fasteners. **Note:** ICAP panels will hang ¾” below the bottom of the j-hook starter. Check local building codes for code requirements above grade and side walks, etc. In the absence of local codes, locate the panels 2 inches (50.8 mm) above side walks, pavement etc. and 4 inches (101.6 mm) Above grade. See Detail
4. **WINDOW/DOORS/PROTRUSION TRIM**

Note: **See Page 11-12 for Door, window & corner trim.**

 - A. Install flashings and trims around windows/doors as required by local building codes.
 - B. Install corner trims as shown on pages **12-13**
 - C. Install Starter Metal at the bottom of the wall as shown on page 10.
 - D. Install Cladding panels from the starter up to the bottom of the window. Notch the panels around the window as required See **Page 11-12.**
5. Proceed installing standard panels, cutting and fitting them to the window trim components as shown in illustrations.

CastleRock Porcelain Panels

Starter Section and first panel installation

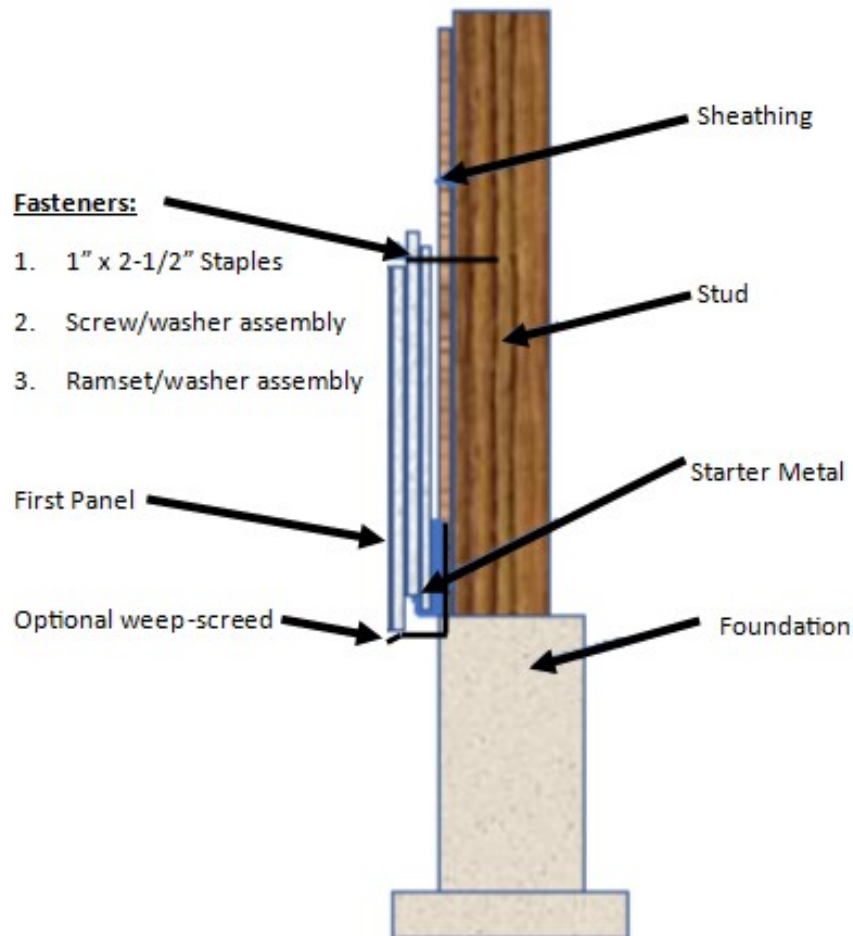

Powder Coated Metal Trim Corners, Door/Window & Termination Trim
Installation for Porcelain Panels
 (This is the fastest & most cost efficient installation method)

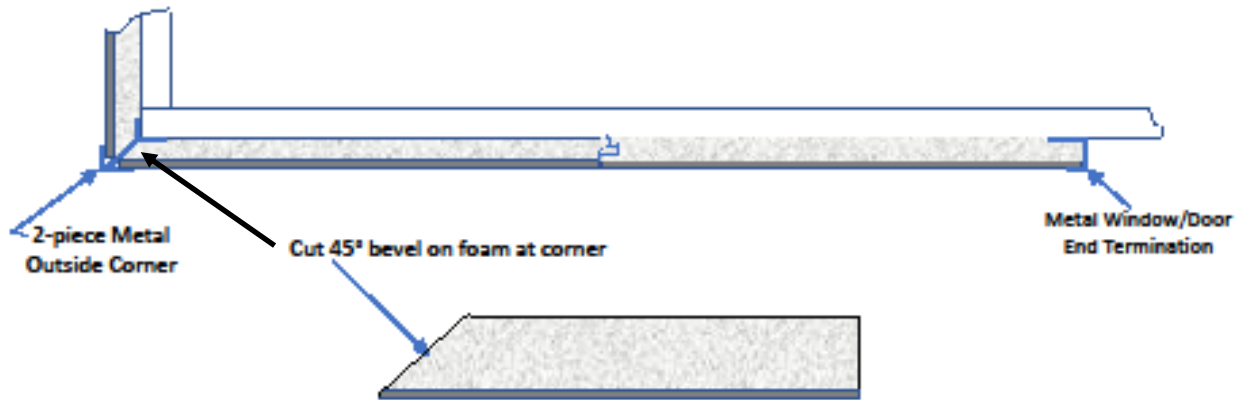

- #1. Install starter metal first.
- #2. Make sure it is level and straight.
- #3. Install vertical outside corner trims, window/door trims, & end termination metal
- #4. Begin at the corner and miter cut the foam at a 45 degree angle as show above.
- #5. Install the first panel with screw/washer assemblies and adjust make sure it is level.
- #6. Continue installing the first row of panels until you reach a door, window or corner
- #7. Square cut the end of panel to the appropriate length and slide between the previous panel and the window/door trim; or at a corner, cut a bevel on the foam to fit the metal trim.
- #8. Begin the next row of panels at the corner. Cut the first panel length to create a vertical joint stagger of 50% or 33-1/3%.
- #9. Repeat the process until the wall section is finished.

Note: Check each row for level and straightness.

Fitting around window/doors: When a row does not align evenly with the panel

Window/Door Trim Sealing

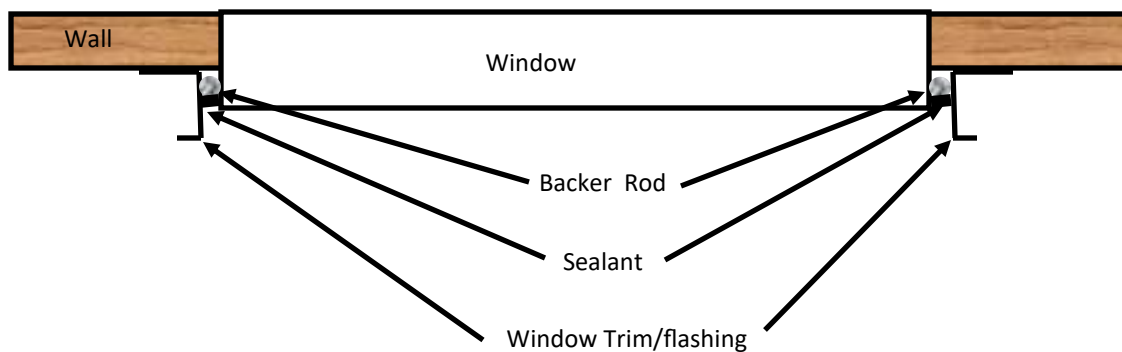

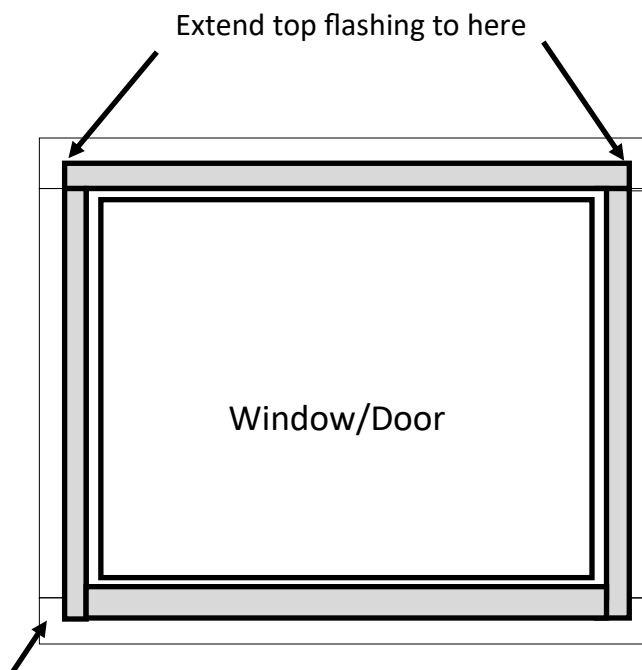

Attach trim with #10 x 2" screws through the trim

Seal window/door flashing and joints watertight to prevent leaks.

Corner Trim Assembly

Attach to the wall and seal to the porcelain watertight to prevent leaks.

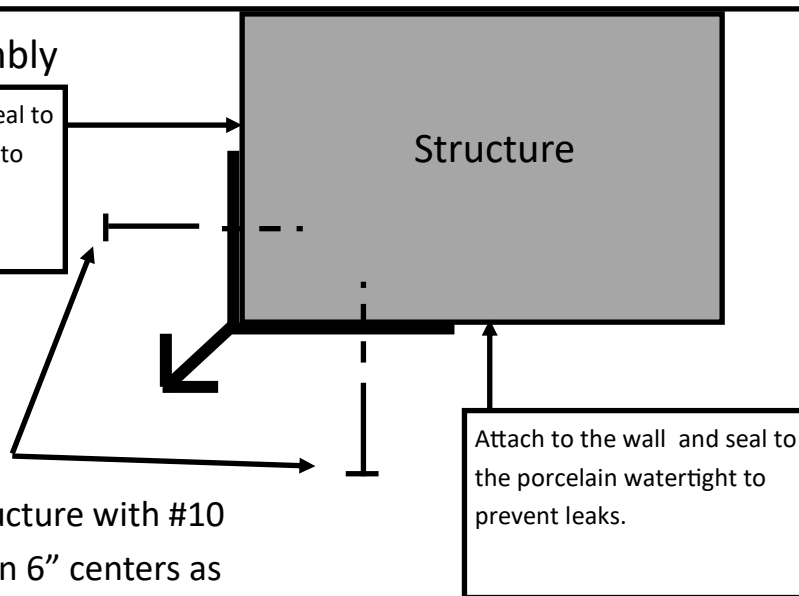

Attach to structure with #10 x 2" screws on 6" centers as shown.

Attach to the wall and seal to the porcelain watertight to prevent leaks.

See alternate Corner installation method on the next page.

Alternate Corner Installation Method

Corners may be installed without the metal trim shown on the previous page. Install with this method for a caulked corner:

Cut and fit the panels at the corners as shown:

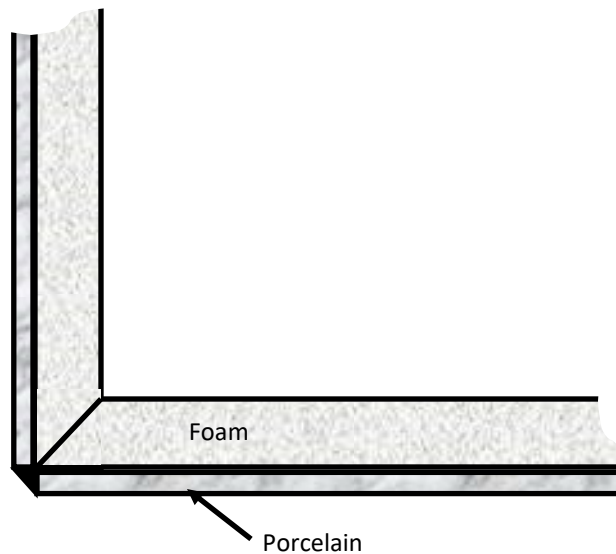

Corner Seal:

Use the following:

Laticrete: Latasil™

Dow: 790 Silicone

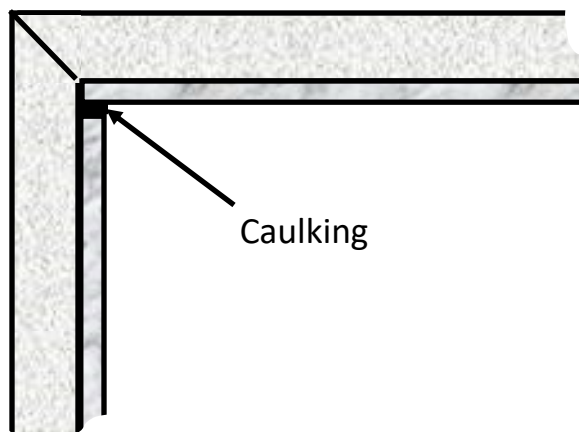

Fiting Around Protrusions/Pentration

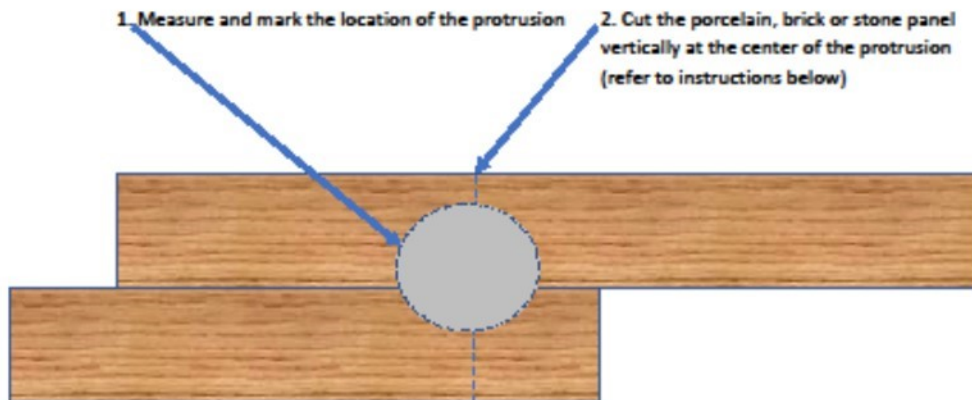

Protrusions never fall where you want them to, so follow these instructions for an easy fit.

Round or irregular protrusions

1. Measure and mark the location of the protrusion
2. Cut the porcelain, brick or stone panel vertically at the center of the protrusion (Use an appropriate sized diamond hole saw to cut the hole)
3. If the hole is larger than your largest hole saw, multiple holes may be required to nibble the correct size opening.
4. Use backer rod and Dow 790 silicone to seal the fascia to the protrusion. Use masking tape on the fascia to create a clean line where the sealant ends. Allow 24 hours to cure, then remove the tape.

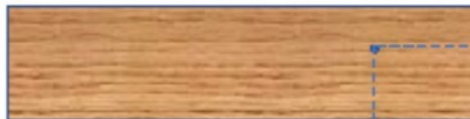

Rectangular Protrusions

Rectangular Protrusions can usually be cut with a diamond blade circular saw. Use a hole saw to drill a hole at each corner of the cut to prevent irregular cracking, then use the circular saw.

Electrical and Plumbing Penetrations:

It is very easy to cut penetrations through the porcelain. Diamond holes saws are inexpensive, available in a variety of sizes and quickly drill through the porcelain. For larger or irregular penetrations, drill 4 holes at the corner of a rectangle or in a pattern for round or irregular shapes. A diamond cutting wheel on a 4-1/2" right angle grinder is ideal for making the cuts between the holes. Use the same method to cut and fit porcelain panels to other walls, etc.

Soffit Termination

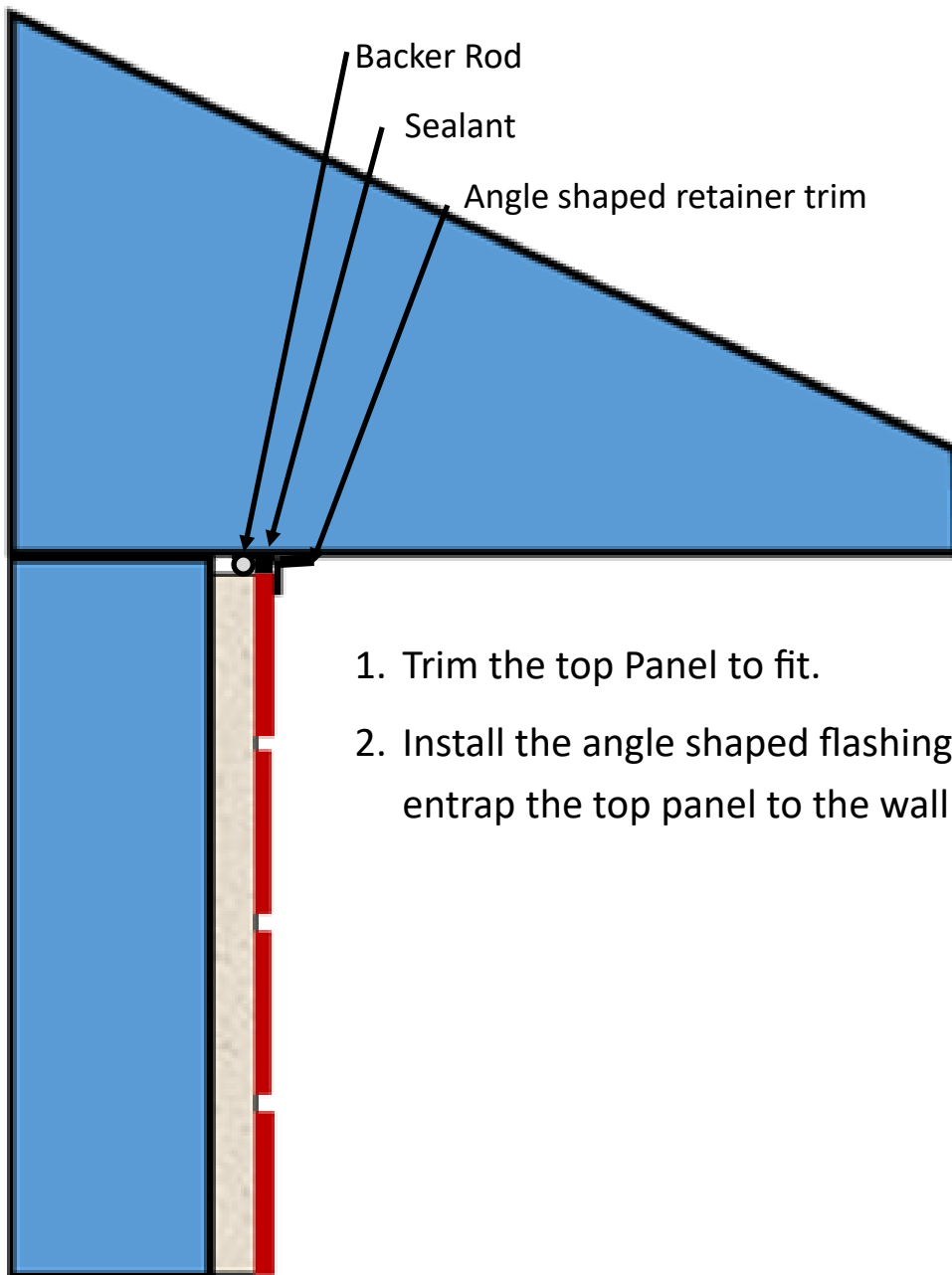

1. Trim the top Panel to fit.
2. Install the angle shaped flashing to the soffit to entrap the top panel to the wall.

e-

Expansion Joints

The CastleRock system is designed to flex and move with the building as it experiences temperature changes and wind loads. Most of the movement will be absorbed by the foam and fastener or by the interlocking tongue and groove assembly, however, expansion joints should be installed at expansion joint locations specified by the architect on the plans and at every floor level but vertical joints must not be further than every 50 ft.

Installing vertical expansion joints

The simplest way to install vertical expansion joints is to install the panels onto the wall first. Then, with a diamond saw or diamond grinder cut a vertical slot through the porcelain and approximately 1/2" into the foam backing. Use backer rod and CastleRock 790 flexible colored silicone sealant or other approved sealant to fill the saw cut. Installing tape on each side of the saw cut prior to caulking to help keep the sealant off of the face of the porcelain.

Installing Horizontal expansion joints

Horizontal expansion joints are usually required at every floor level of multi-story buildings. Install panels up to the horizontal expansion joint location. Use a spacer the thickness of the specified expansion joint up to 3/8" to separate the porcelain to the correct distance for compression. The upper panel is attached above the expansion joint and the lower panel is attached below the expansion joint. The panels can move with the building up to 3/8". The CastleRock panel tongue is 1-1/2" wide and gapping the joint will not cause negative issues.

See page 17 Illustrations

Expansion. Contraction Joints

Lap Siding Panels:

Lap siding naturally expands in horizontal joints because of design and overlap. End to end expansion joints can be accomplished by locating an expansion joint as shown and sealing with a flexible sealant. These sealants are durable, but should be inspected annually and repaired if necessary.

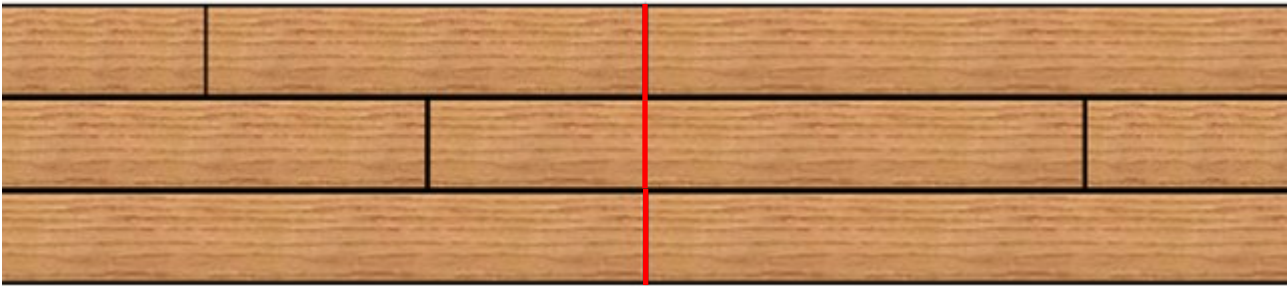

Expansion. Contraction Joints

Flush non-grouted Siding Panels:

Flush non-grouted siding panels also have natural movement due to the interlocking tongue and groove design, but require expansion joints at building expansion locations or as specified by the architect or local codes.

Common locations are at each floor/story level and where vertical building expansion joints are located. Expansion joint sealant should be inspected annually and repaired if necessary.



Horizontal Expansion Joint at each floor/story. Flush panel joints require CastleRock 790 sealant or other equivalent. flexible sealant*

* Not required on lap siding

Grouted Joint Siding Panels:

If using grout at joints, Porcelain Panels require expansion joints as recommended by "Ceramic Tile Institute of America" and at each floor level/story and building expansion joint. The flexible expansion joint should be inspected annually and repaired if necessary.

Multi-floor Level Expansion/Contraction Joints

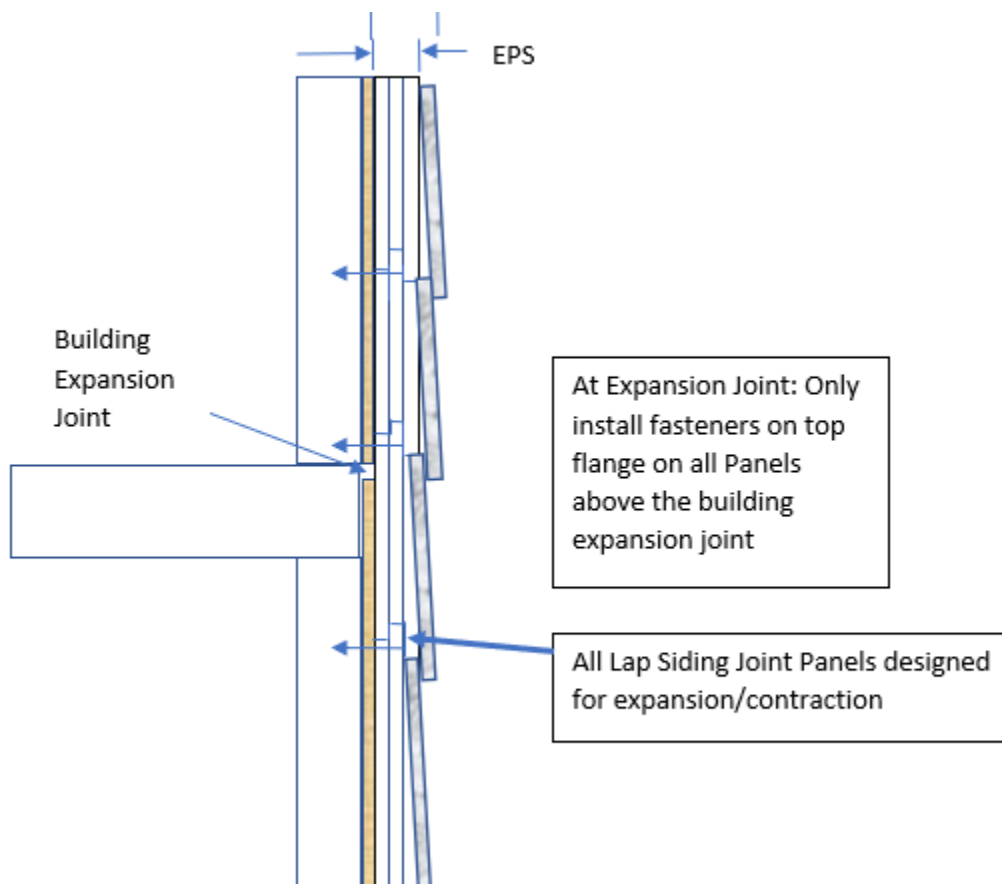
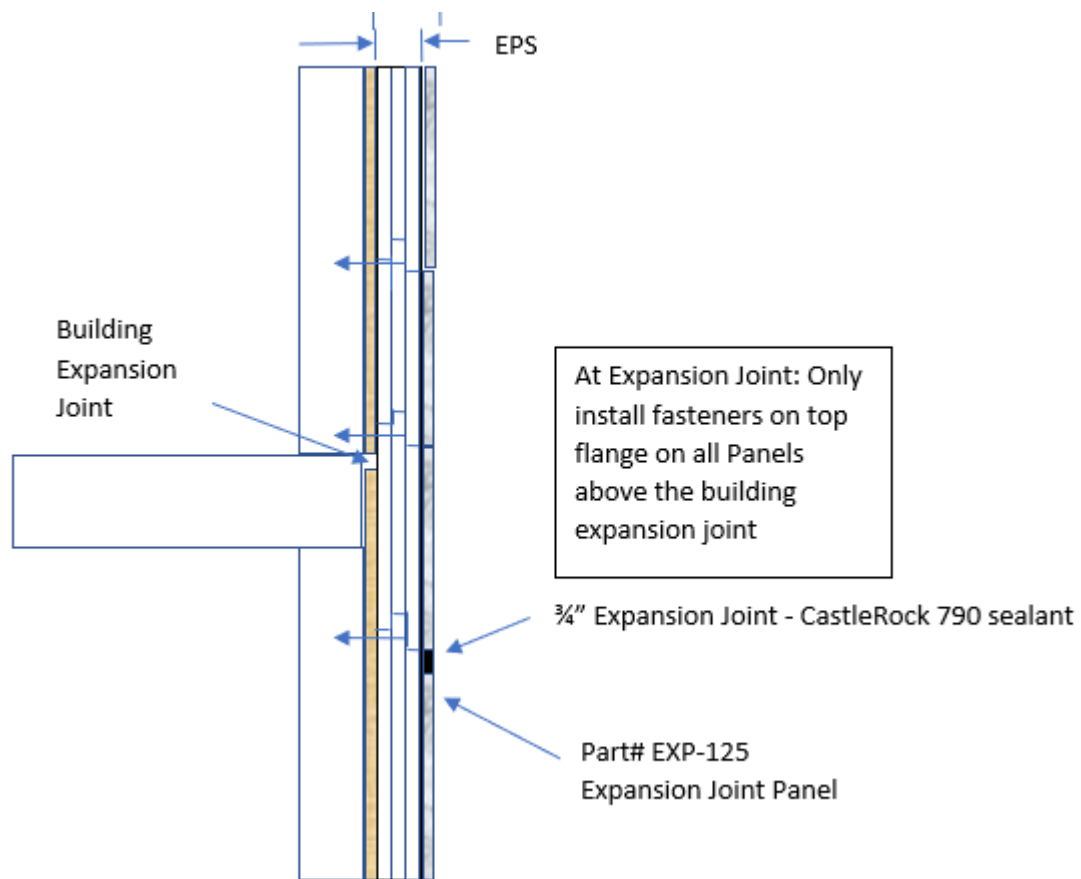

Brick Panel joint alignment



When installing Brick Panels, the grout joints are commonly staggered as shown. When installing the first row, the end panel will need to be cut to adjust the fixed sizes of the panels to the length of the wall. After cutting to fit the metal trim, you can usually use the section you removed to begin the next row with. If the removed piece is shorter than 1/2 brick length, a new panel will need to be used to start the next row.

Window/Door Termination & Corner fit & Caulking Instructions

Top View

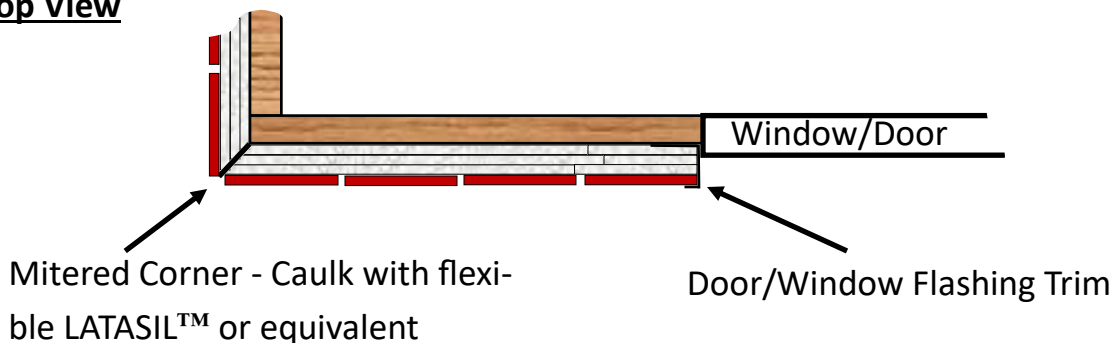

Soffit Termination

Top View

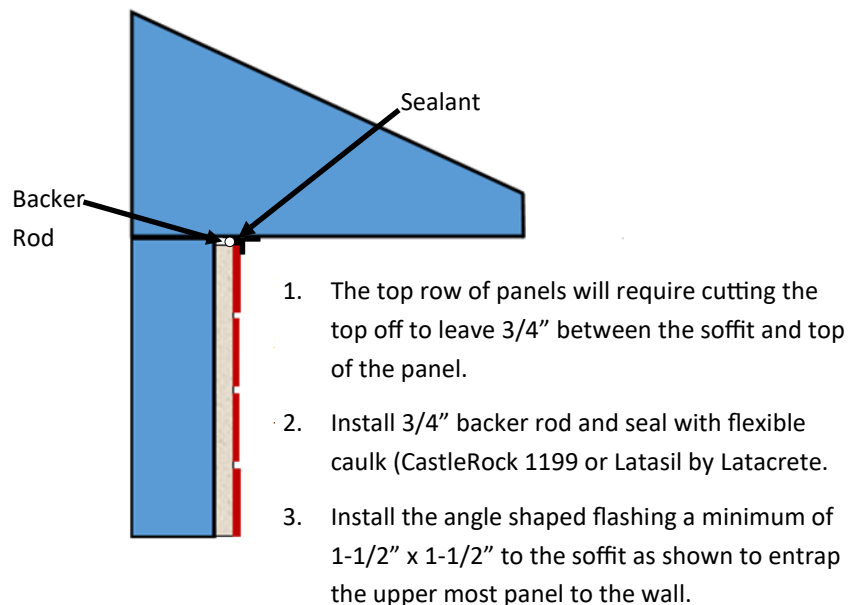

Horizontal Expansion/Contraction Joint

CastleRock Brick Panels

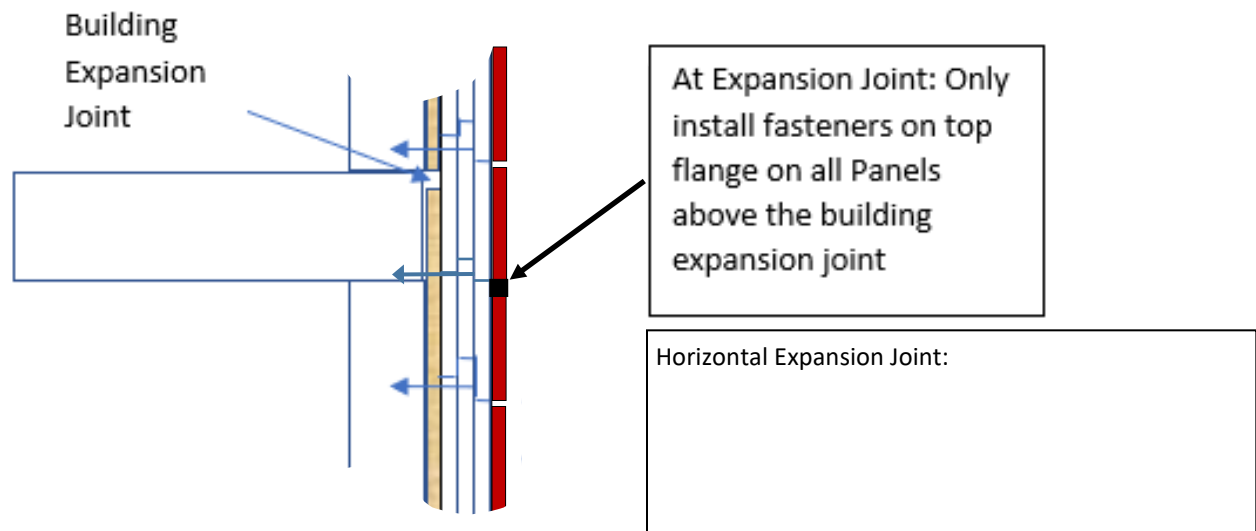

Porcelain Maintenance

Porcelain is one of the most dense, water resistant materials available. It will not warp, shrink, burn and is resistant to most chemicals. It never fades or discolors. The grout is another story, so be careful cleaning grout and follow the manufacturers cleaning instructions.

Mild Cleaning

Clean Your Porcelain with Water

Don't underestimate water. It's the foundation of most cleaners and has stellar cleaning properties when you use it by itself. The beauty of cleaning with water is that you're not using any harmful agents that might leave a residue.

Water is safe to use and will clean away a surprising amount of grime.

Stains and hard water spots

Deal with Porcelain Stains with Ammonia

Ammonia is a fantastic cleaner that you can use to clean windows and soothe wasp stings, and it will get your porcelain back to new condition in a hurry. You shouldn't use ammonia to clean your porcelain every time you clean, though, as repeated use is not good for porcelain.

But, when you encounter a stain that won't go away no matter what you do, ammonia is just what you need.

Power Washing

Gentle Power Washing works quite well and is fast. Grouts do not fair well under high pressure. House Cleaner or Ammonia with a gentle spray will clean most walls. Put on your rubber glove and use a soft sponge for difficult dirt or stains,

Caution: Styrofoam Insulation backing on Porcelain Panels

Do not use petroleum based cleaners or allow the Styrofoam insulation to be exposed to direct sunlight for extended periods of time.

CastleRock Insulated Porcelain Siding

Phone: 208-895-8557

e-mail: info@castlerockx.com

www.castlerockx.com

Po Box 1258 Meridian, ID 83680

WHAT DOES THE LIMITED WARRANTY COVER?

InsulStone, Inc., CastleRock™ warrants to the original purchaser/consumer at the time the products are installed, to be free from defects in material and workmanship in the course of manufacture.

This warranty is limited to the terms and conditions, exclusions and limitations, requirements and legal rights stated in this Warranty. In the event of repair or replacement under the terms of this warranty, the original warranty shall be limited to replacement or repair of the defective product and will extend for the balance of the warranty period from the date of the original installation. The coverage offered by this Express Limited Materials Warranty to the original purchaser and may only be transferrable to subsequent purchasers with the prior written approval of CASTLEROCK.

WHO IS COVERED AND HOW LONG DOES THE COVERAGE LAST?

Should a material defect occur within 10 years of the original purchase by the registered purchaser, the manufacturer will in its sole discretion, replace the defective product before it is installed, or, during the first 5 years, reimburse the party for losses up to no more than twice the manufacturers selling price of the defective portion of the Product. After the 10th year all warranty coverage shall cease and the warranty coverage shall be terminated. The Manufacturer's replacement of the defective product or granting of a refund pursuant to this Warranty shall be in its sole discretion and the sole exclusive remedy available to the covered party with respect to any defect. MANUFACTURER WILL NOT REFUND OR PAY ANY COSTS IN CONNECTION WITH LABOR OR ACCESSORY MATERIALS.

WHAT DOESN'T THIS WARRANTY COVER?

This warranty does not cover damage of any kind resulting from: Faulty or improper installation

Any and all labor for repair or replacement of warranted parts.
Shipping costs for replacement parts.
Movement, waving, buckling, or other distortions.
Damage from impact or contact with foreign objects, chemicals, etc.
Damage from failure to properly maintain the Product.
Installation of the Product in direct contact with dissimilar materials or use of incompatible caulking, adhesives, fumes, vapors or coating.
Changes in the surface color resulting from exposure to the elements (i.e. soiling, staining or discoloring resulting from local conditions which InsulStone, Inc. has no control over.
Settlement or shrinkage of the property or structure.
Fire or heat from barbecues, heaters, vents, etc.
Lightning, hurricane, tornado, windstorm, earthquake, hail, snow or ice accumulation, or other acts of God.
Surface deterioration from air pollution, or seacoast environment.
Abuse, misuse, vandalism, or abrasion.

Product that has been painted, coated, colored or altered.
Chips, cracks that do not affect the performance of the Product are not covered under this warranty.
Any other causes beyond InsulStone/CASTLEROCK's reasonable control.
Substitution or use of specialty parts not listed in CASTLEROCK's standard parts and price list.

OTHER LIMITATIONS:

CASTLEROCK cladding is designed for use as exterior cladding installed in accordance with its published installation instructions and should not be used as roofing, floors, on ceilings, or in locations that require water tight protection.

We reserve the right to discontinue or change any design, color or texture, of any of our products at any time and without notice or liability. If, for any reason, you make a warranty claim and the product type originally installed is no longer available, we may substitute another product determined by us to be of comparable quality and price.

There are no warranties expressed, implied or written that CASTLEROCK accepts responsibility for other than this Warranty.

4. ICAP-USA IS NOT RESPONSIBLE FOR ANY CONSEQUENTIAL OR INCIDENTAL DAMAGES ARISING OUT OF ANY BREACH OF THIS EXPRESSED WARRANTY, OR ANY OTHER ORAL, WRITTEN OR IMPLIED WARRANTY THAT MAY APPLY TO YOUR PURCHASE, AS IT RELATES TO OUR PRODUCTS.

5. THIS IS YOUR EXCLUSIVE WARRANTY AND IS IN LIEU OF ALL OTHER WARRANTIES, EXPRESSED OR IMPLIED, INCLUDING BUT NOT LIMITED TO IMPLIED WARRANTIES OF MERCHANTABILITY AND FITNESS.

This warranty gives you specific legal rights. You may also have other rights which vary from state to state. SOME STATES DO NOT ALLOW THE EXCLUSION OR LIMITATION OF INCIDENTAL OR CONSEQUENTIAL DAMAGES, SO THE ABOVE LIMITATION OR EXCLUSION MAY NOT APPLY TO YOU. FAILURE OF PART OF THIS WARRANTY TO COMPLY WITH LOCAL OR FEDERAL LAW DOES NOT VOID DOCUMENT IN ITS ENTIRETY. This warranty shall be interpreted under the laws of the State of Idaho.

HOW DO I REGISTER THIS WARRANTY?

One application per property location where CASTLEROCK/InsulStone, Inc. cladding is installed must be completed and mailed to CASTLEROCK/InsulStone, Inc. P.O. Box 1258 Meridian, ID 83680 within 30 days after the original installation has been completed. The notice should include the following: (1) Name of owner

(2) Address of property or location of the installation (3) Date of purchase (4) Proof of purchase

HOW DO YOU SUBMIT A WARRANTY CLAIM?

You must submit a claim in writing with us within the warranty period and within a reasonable period of time after the defect is discovered. To initiate the claim, please go to www.CastleRockx.com, contact us at sales.icap@gmail.com or by mail at:

CASTLEROCK/InsulStone, Inc., PO Box 1258, Meridian, ID 83680.

Phone#: 208.895.8557

ANY REPAIR OF THE PRODUCTS UNDERTAKEN WITHOUT PRIOR WRITTEN AUTHORIZATION FROM CASTLEROCK/INSULSTONE, INC. PRIOR TO RECEIVING WRITTEN APPROVAL FROM INSULSTONE, INC. WILL VOID THIS WARRANTY.

This Warranty is effective as of 09/01/2021 and replaces all prior warranties.

Owner _____
Installation Address: _____
Name of installing Contractor: _____ Date Installed: _____
Date of Completion: _____
Phone # _____ Owner Signature _____

Return a copy of this Limited Materials Warranty to CASTLEROCK PO Box 1258 Meridian, ID 83680